

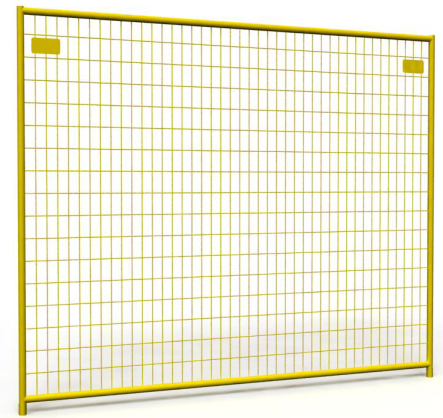

Information - RF-10005/RF-10006 Single Perimeter Patrol Panel

- Panel is durable and weighs 37 lbs.
- 8 gauge welded wire
- 2" x 4" wire mesh
- 87" w x 72" h panel with center vertical support bar
- Durable 2 step finish
– zinc enriched primer coat is covered with Tiger Yellow powder, final coat.

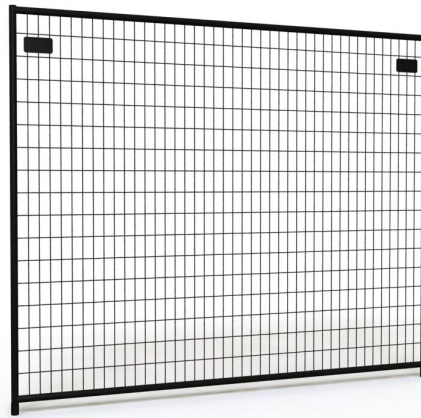

Specifications RF-10005/RF-10006

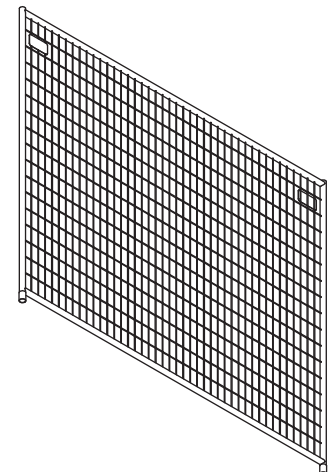
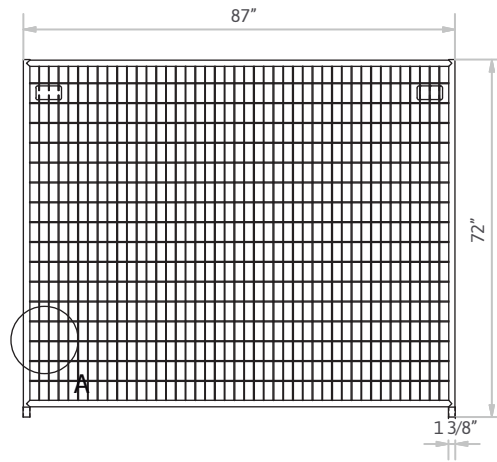
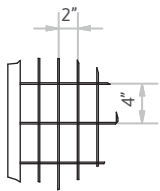

STANDARD COLORS  